

SEAT

To remove the seat, insert the ignition key (1) into the lock (2) and turn it counter-clockwise.

Remove the seat by pulling up and rearward.

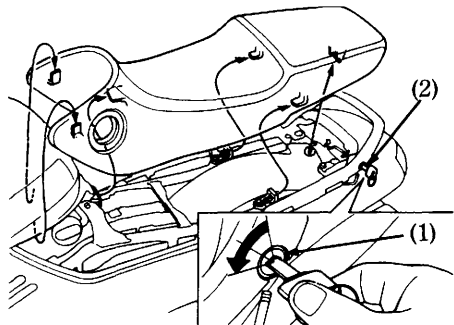

(1) Ignition key

(2) Seat lock

38

CORD HOOK

This motorcycle is equipped with the retractable luggage cord hooks (1).

CAUTION:

*** Never use this cord hook to tow or lift the motorcycle.**

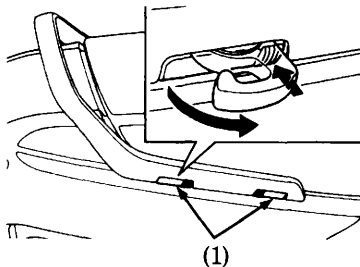

(1) Cord hooks