

## Tool Kit

---

The tool kit (1) is stored in the storage compartment (2) behind the left side cover (page 76).

An optional, larger tool kit may be available. Check with your Honda dealer's parts department.

To open the storage compartment, remove the left side cover (page 76). Insert the ignition key (3) and turn it 90 degrees counterclockwise. Open the storage compartment lid (4).

To close the storage compartment, close the storage compartment lid. Turn the ignition key 90 degrees clockwise and remove it. Install the left side cover (page 76).

### LEFT SIDE

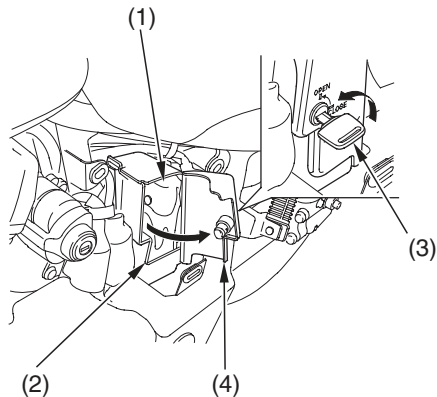

- |                         |                             |
|-------------------------|-----------------------------|
| (1) tool kit            | (3) ignition key            |
| (2) storage compartment | (4) storage compartment lid |