

CYLINDER HEAD COVER • INLET PIPE • SPARK PLUG

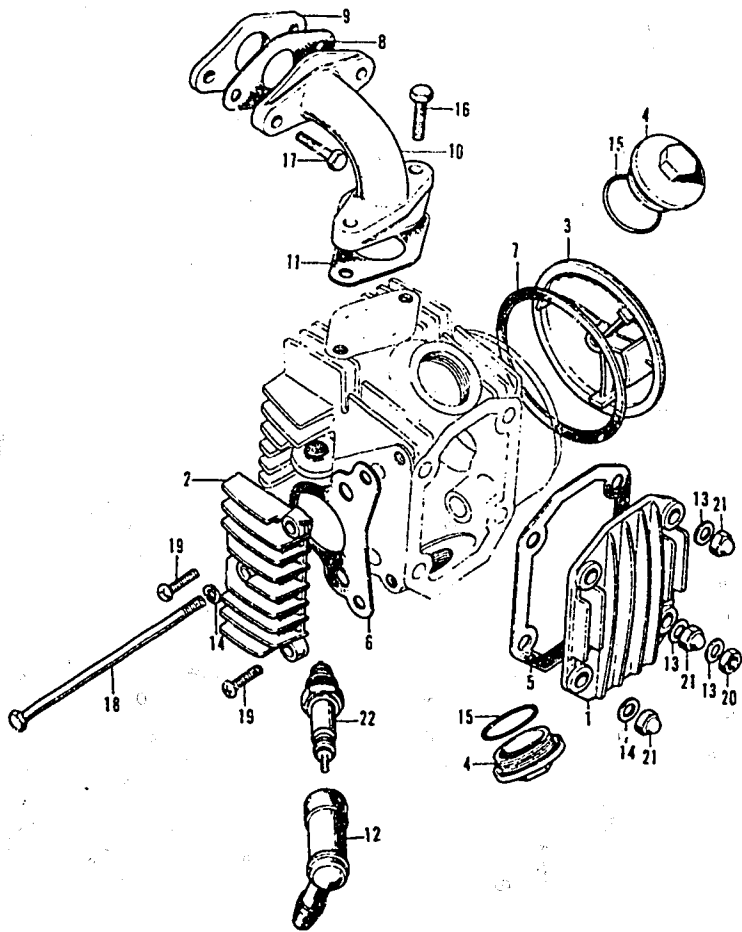

E23098001

K1 = CT70K1
K2 = CT70K2

Ref. No.	BLOCK NO. DESCRIPTION	CT70		ENGINE SERIAL NUMBER		QTY	PART NUMBER	HONDA CODE
		K1	K2	FROM	TO			
		1	2					
1	COVER, CYLINDER HEAD	K1	K2	---	---	1	12301-035-000	0069591
2	COVER, R. CYLINDER HEAD SIDE	K1	K2	---	---	1	12331-035-000	0069609
3	COVER, L. CYLINDER HEAD SIDE	K1	K2	---	---	1	12341-035-000	0069617
4	CAP, TAPPET ADJUSTING HOLE	K1	K2	---	---	2	12361-035-000	0069625
	CAP, TAPPET ADJUSTING HOLE	K1	K2	---	---	2	12361-300-000	0188870
	CAP, TAPPET ADJUSTING HOLE	K1	K2	---	---	2	12361-371-980	0454934
5	GASKET, CYLINDER HEAD COVER	K1	K2	---	---	1	12391-035-000	0069666
6	GASKET, R. CYLINDER HEAD SIDE COVER	K1	K2	---	---	1	12394-035-000	0069674
7	GASKET, L. CYLINDER HEAD SIDE COVER	K1	K2	---	---	1	12395-035-000	0069682
	GASKET, CYLINDER HEAD SIDE, L.	K1	K2	---	---	1	12395-035-306	4314001
8	GASKET, INSULATOR	K1	K2	---	---	1	16201-098-000	0114710
9	INSULATOR, CARBURETOR	K1	K2	---	---	1	16211-098-000	0114728
10	PIPE, IN.	K1	K2	---	---	1	17111-098-000	0114736
11	GASKET, IN. PIPE	K1	K2	---	---	1	17119-035-000	0069690
12	CAP, SPARK PLUG	K1	K2	---	---	1	30700-098-153	0349266
	CAP, SUPPRESSOR	K1	K2	---	---	1	30700-098-158	1011568
	CAP, SPARK PLUG	K1	K2	---	---	1	30700-098-163	3613890
	CAP ASSY., NOISE SUPPRESSOR	K1	K2	---	---	1	30700-259-810	0100396
13	WASHER, SEALING, 6MM	K1	K2	---	---	3	90442-035-000	0070961
14	WASHER A, SEALING, 6MM	K1	K2	---	---	2	90443-035-000	0070987
15	O-RING, 30.8MM	K1	K2	---	---	2	91302-001-020	0001065
16	BOLT, HEX., 6X20	K1	K2	---	---	2	92000-06020	0054270
	BOLT, HEX., 6X20	K1	K2	---	---	2	92101-06020-0A	2528925
17	BOLT, HEX., 6X25	K1	K2	---	---	2	92000-06025	0054320
	BOLT, HEX., 6X25	K1	K2	---	---	2	92101-06025-0A	2206563
18	BOLT, HEX., 6X112	K1	K2	---	---	1	92000-06112	0197707
19	SCREW, PAN, 6X20	K1	K2	---	---	2	93500-06020	0057497
20	NUT, HEX., 6MM	K1	K2	---	---	1	90310-KA3-711	1553916
	NUT, HEX., 6MM	K1	K2	---	---	1	94000-06000-0S	1391283
	NUT, HEX., 6MM	K1	K2	---	---	1	94001-06000	0058016
	NUT, HEX., 6MM	K1	K2	---	---	1	94001-06000-0S	0156067

B1

CONTENTS

TITLE	PAGE	GRID
AIR CLEANER	60	D11
ALTERNATOR	10	B5
BATTERY	88	F1
BRAKE PEDAL	80	S9
CAM CHAIN TENSIONER	14	B7
CAMSHAFT	8	B4
CARBURETOR	38	C7
CHAIN CASE	78	E8
CHANGE PEDAL	98	F6
CLUTCH	18	B9
CRANKCASE	34	C5
CRANKCASE COVER, L.	10	B5
CRANKCASE COVER, R.	16	B8
CRANKCASE PROTECTOR	92	F3
CRANKSHAFT	22	B11
CYLINDER	6	B3
CYLINDER HEAD	6	B3
CYLINDER HEAD COVER	2	B1
FENDER, FR.	46	D4
FENDER, RR.	84	E11
FORK, FR.	50	D6
FRAME	92	F3
FUEL TANK	64	E1
GEARSHIFT	26	C1
HANDLEBAR	40	D1
HEADLIGHT	44	D3
HORN	46	D4
INLET PIPE	2	B1
KICK ARM	98	F6
KICK STARTER	32	C4
MUFFLER	66	E2
OIL PUMP	34	C5
PISTON	22	B11
SEAT	60	D11
SHOCK ABSORBER, RR.	76	E7
SIDE STAND	80	E9
SPARK PLUG	2	B1
SPEEDOMETER	44	D3
STEERING STEM	46	D4
STEP	80	E9
SWINGARM	78	E8
TAILLIGHT	84	E11
TOOL SET	86	F5
TRANSMISSION	30	C3
VALVE	8	B4
WHEEL, FR.	54	D8
WHEEL, RR.	70	E4
WIRE HARNESS	88	F1

GRID

B1

CT70K1 ENGINE NO.; CT70E-2000001 TO SUBSEQUENT
 CT70K1 FRAME NO.; CT70-2000001 TO SUBSEQUENT
 CT70K2 ENGINE NO.; CT70E-2100001 TO SUBSEQUENT
 CT70K2 FRAME NO.; CT70-2100001 TO SUBSEQUENT

AMERICAN HONDA MOTOR CO., LTD. 1993