

CLUTCH

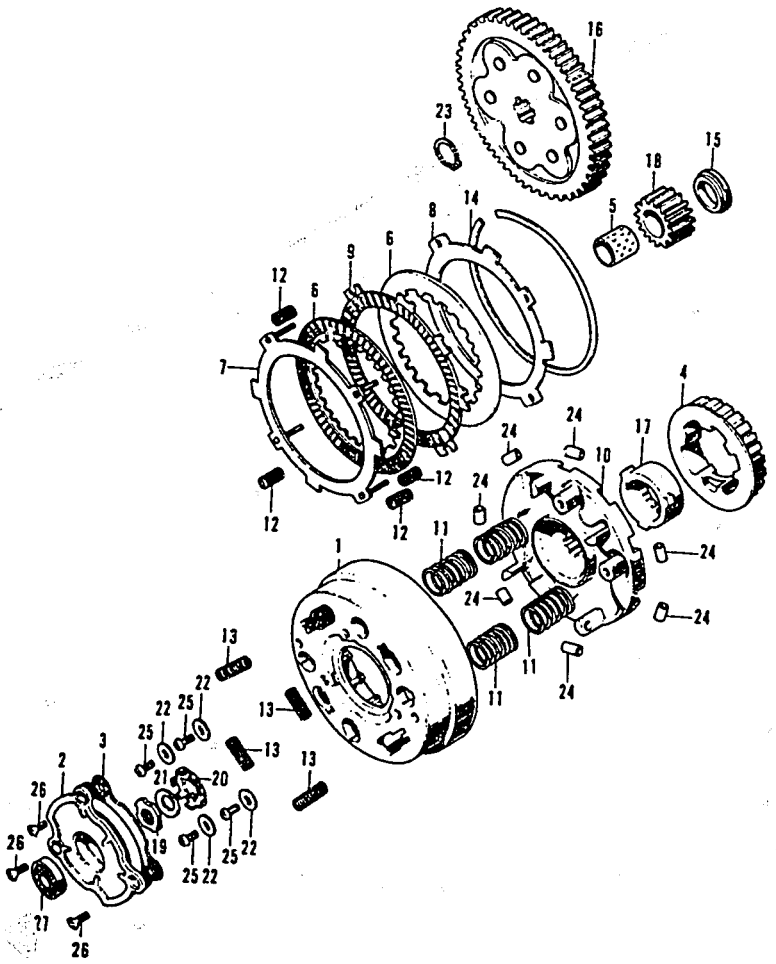

E23098007

K1 = CT70K1
K2 = CT70K2

Ref. No.	BLOCK NO. DESCRIPTION	CT70		ENGINE SERIAL NUMBER		QTY REQ	PART NUMBER	HONDA CODE
		K1	K2	FROM	TO			
		1	2					
1	OUTER, CLUTCH	K1	K2	---	---	1	22101-040-030	0181503
2	COVER, CLUTCH OUTER	K1	K2	---	---	1	22111-040-000	0174623
3	GASKET, CLUTCH OUTER COVER	K1	K2	---	---	1	22119-040-000	0174631
4	CENTER, CLUTCH (17T)	K1	K2	---	---	1	22120-040-030	0203869
5	GUIDE, CLUTCH CENTER	K1	K2	---	---	1	22131-035-020	0123752
6	DISK A, CLUTCH FRICTION	K1	K2	---	---	2	22201-086-010	3134228
7	PLATE A, CLUTCH	K1	K2	---	---	1	22310-680-910	1076702
8	PLATE B, CLUTCH	K1	K2	---	---	1	22321-041-000	0174664
9	DISK B, CLUTCH FRICTION	K1	K2	---	---	1	22331-6W8-681	3853645
10	PLATE, DRIVE	K1	K2	---	---	1	22351-786-010	0270827
11	SPRING, CLUTCH	K1	K2	---	---	4	22701-092-010	0270850
12	SPRING, CLUTCH FREE	K1	K2	---	---	4	22411-092-000	0270868
13	SPRING, CLUTCH DAMPER	K1	K2	---	---	4	22421-040-06J	0174714
14	SET RING, 101.5MM	K1	K2	---	---	1	22901-001-000	0003343
15	COLLAR, 17MM	K1	K2	---	---	1	22911-684-680	1815059
16	GEAR, PRIMARY DRIVEN (69T)	K1	K2	---	---	1	23110-086-020	0270835
17	OUTER, DRIVE GEAR (17T)	K1	K2	---	---	1	23112-086-020	0270785
18	GEAR, PRIMARY DRIVE (17T)	K1	K2	---	---	1	23120-086-020	0270793
19	NUT, LOCK, 14MM	K1	K2	---	---	1	90231-087-000	0185231
20	WASHER, LOCK, 14MM	K1	K2	---	---	1	90431-086-000	0269035
21	WASHER B, LOCK	K1	K2	---	---	1	90432-086-000	0270744
22	WASHER, STOPPER, 5MM	K1	K2	---	---	4	90483-040-000	0085795

CONTENTS

TITLE	PAGE	GRID
AIR CLEANER	60	D11
ALTERNATOR	10	B5
BATTERY	88	F1
BRAKE PEDAL	80	E9
CAM CHAIN TENSIONER	14	B7
CAMSHAFT	8	B4
CARBURETOR	38	C7
CHAIN CASE	78	E8
CHANGE PEDAL	98	F6
CLUTCH	18	B9
CRANKCASE	34	C5
CRANKCASE COVER L	10	B5
CRANKCASE COVER R	16	B8
CRANKCASE PROTECTOR	92	F3
CRANKSHAFT	22	B11
CYLINDER	6	B3
CYLINDER HEAD	6	B3
CYLINDER HEAD COVER	2	B1
FENDER FR	46	D4
FENDER RR	84	E11
FORK FR	50	D6
FRAME	92	F3
FUEL TANK	64	E1
GEARSHIFT	26	C1
HANDLEBAR	40	D1
HEADLIGHT	44	D3
HORN	46	D4
INLET PIPE	2	B1
KICK ARM	98	F6
KICK STARTER	32	C4
MUFFLER	66	E2
OIL PUMP	34	C5
PISTON	22	B11
SEAT	60	D11
SHOCK ABSORBER RR	76	E7
SIDE STAND	80	E9
SPARK PLUG	2	B1
SPEEDOMETER	44	D3
STEERING STEM	46	D4
STEP	80	E9
SWINGARM	78	E8
TAILLIGHT	84	E11
TOOL SET	96	F5
TRANSMISSION	30	C3
VALVE	8	B4
WHEEL FR	54	D8
WHEEL RR	70	E4
WIRE HARNESS	88	F1

18 © AMERICAN HONDA MOTOR CO., LTD. 1993
 CT70K1 ENGINE NO.; CT70E-2000001 TO SUBSEQUENT
 CT70K1 FRAME NO.; CT70-2000001 TO SUBSEQUENT
 CT70K2 ENGINE NO.; CT70E-2100001 TO SUBSEQUENT
 CT70K2 FRAME NO.; CT70-2100001 TO SUBSEQUENT

© AMERICAN HONDA MOTOR CO., LTD. 1993 19