

GEARSHIFT

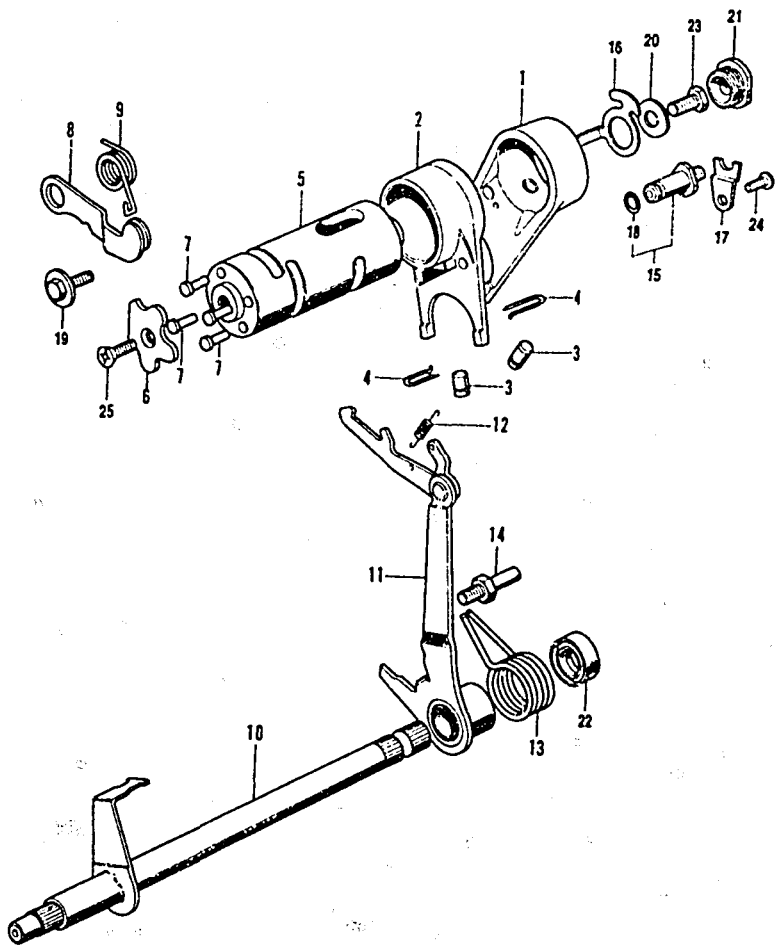

E23068009

K1 = CT70K1
K2 = CT70K2

Ref. No.	BLOCK NO. DESCRIPTION	CT70		ENGINE SERIAL NUMBER	QTY REQ	PART NUMBER	HONDA CODE
		K1	K2				
		FROM	TO				
20	WASHER, GEARSHIFT DRUM SIDE	K1	K2	-----	1	90417-041-000	0124057
21	PLUG, RUBBER, 19MM	K1	K2	-----	1	90801-035-000	0069500
22	OIL SEAL, 11.6X24X10	K1	K2	-----	1	91203-001-000	0004986
	OIL SEAL, 11.6X24X10	K1	K2	-----	1	91204-035-000	0185652
	OIL SEAL, 11.6X24X10	K1	K2	-----	1	91204-035-003	0827980
	OIL SEAL, 11.6X24X10	K1	K2	-----	1	91204-121-000	0433946
	OIL SEAL, 11.6X23X10 (ARAI)	K1	K2	-----	1	91208-KB4-671	2043149
23	BOLT, HEX., 6X16	K1	K2	-----	1	92000-06016	0054239
	BOLT, HEX., 6X16	K1	K2	-----	1	92000-06016-0A	0313197
	BOLT, HEX., 6X16	K1	K2	-----	1	92000-06016-1A	0915124
	BOLT, HEX., 6X16	K1	K2	-----	1	92100-06016-0A	1685726
	BOLT, HEX., 6X16	K1	K2	-----	1	92101-06016-0A	2479590
	BOLT, HEX., 6X16	K1	K2	-----	1	92200-06016-0A	1842400
24	SCREW, PAN, 6X12	K1	K2	-----	1	93500-06012	0057422
	SCREW, PAN, 6X12	K1	K2	-----	1	93500-06012-0A	0182360
	SCREW, PAN, 6X12	K1	K2	-----	1	93500-06012-00	2711489
25	SCREW, OVAL, 6X20	K1	K2	-----	1	93700-06020	0056515
	SCREW, OVAL, 6X20	K1	K2	-----	1	93700-06020-0A	2450856

AMERICAN HONDA MOTOR CO., LTD. 1993 29

CONTENTS

TITLE	PAGE	GRID
AIR CLEANER	60	D11
ALTERNATOR	10	B5
BATTERY	88	F1
BRAKE PEDAL	80	E9
CAM CHAIN TENSIONER	14	B7
CAMSHAFT	8	B4
CARBURETOR	38	C7
CHAIN CASE	78	E8
CHANGE PEDAL	98	F6
CLUTCH	18	B9
CRANKCASE	34	C5
CRANKCASE COVER, L	10	B5
CRANKCASE COVER, R	16	B8
CRANKCASE PROTECTOR	92	F3
CRANKSHAFT	22	B11
CYLINDER	6	B3
CYLINDER HEAD	6	B3
CYLINDER HEAD COVER	2	B1
FENDER, FR	46	D4
FENDER, RR	84	E11
FORK, FR	50	D6
FRAME	92	F3
FUEL TANK	64	E1
GEARSHIFT	26	C1
HANDLEBAR	40	D1
HEADLIGHT	44	D3
HORN	46	D4
INLET PIPE	2	B1
KICK ARM	98	F6
KICK STARTER	32	C4
MUFFLER	66	E2
OIL PUMP	34	C5
PISTON	22	B11
SEAT	60	D11
SHOCK ABSORBER, RR	76	E7
SIDE STAND	80	E9
SPARK PLUG	2	B1
SPEEDOMETER	44	D3
STEERING STEM	46	D4
STEP	80	E9
SWINGARM	78	E8
TAILLIGHT	84	E11
TOOL SET	96	F5
TRANSMISSION	30	C3
VALVE	8	B4
WHEEL, FR	54	D8
WHEEL, RR	70	E4
WIRE HARNESS	88	F1

28 AMERICAN HONDA MOTOR CO., LTD. 1993
 CT70K1 ENGINE NO.; CT70E-2000001 TO SUBSEQUENT
 CT70K1 FRAME NO.; CT70-2000001 TO SUBSEQUENT
 CT70K2 ENGINE NO.; CT70E-2100001 TO SUBSEQUENT
 CT70K2 FRAME NO.; CT70-2100001 TO SUBSEQUENT