

# TRANSMISSION

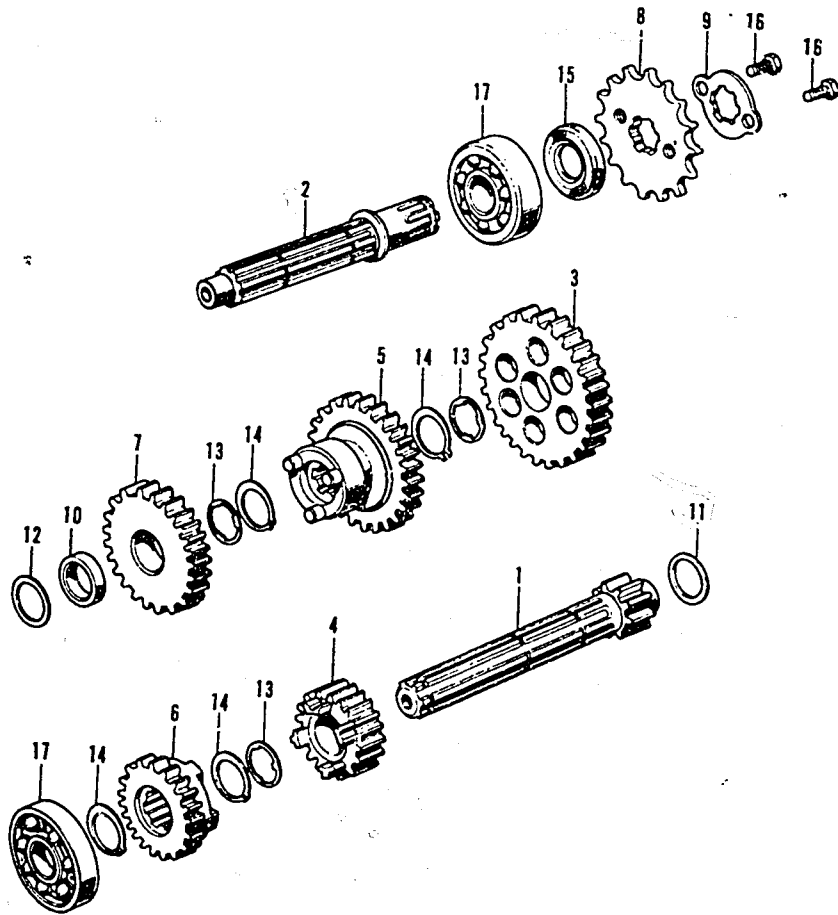

E23098010

K1 = CT70K1  
K2 = CT70K2

Ref. No.	BLOCK NO. DESCRIPTION	CT70		ENGINE SERIAL NUMBER		QTY REQ	PART NUMBER	HONDA CODE
		K1	K2	FROM	TO			
1	MAINSHAFT, TRANSMISSION (11T) ...	K1	K2	-----	-----	1	23211-041-020	0174805
2	COUNTERSHAFT, TRANSMISSION .....	K1	K2	-----	-----	1	23221-041-040	0174813
	COUNTERSHAFT, TRANSMISSION .....	K1	K2	-----	-----	1	23221-041-050	1783877
3	GEAR, COUNTERSHAFT LOW (36T) ....	K1	K2	-----	-----	1	23421-086-000	0270801
	GEAR, COUNTERSHAFT LOW (36T) ....	K1	K2	-----	-----	1	23421-086-010	0925461
4	GEAR, MAINSHAFT SECOND (18T) ....	K1	K2	-----	-----	1	23431-040-060	0201343
	GEAR, COUNTERSHAFT SECOND (31T) .	K1	K2	-----	-----	1	23441-086-000	0270819
	GEAR, COUNTERSHAFT SECOND (31T) .	K1	K2	-----	-----	1	23441-086-010	1092493
6	GEAR, MAINSHAFT TOP (21T) .....	K1	K2	-----	-----	1	23471-041-040	0174854
7	GEAR, COUNTERSHAFT TOP (25T) ....	K1	K2	-----	-----	1	23481-086-000	0270751
	GEAR, COUNTERSHAFT THIRD (25T) ..	K1	K2	-----	-----	1	23481-086-010	1092519
8	SPROCKET, DRIVE (15T) .....	K1	K2	-----	-----	1	23800-098-000	0114850
9	PLATE, DRIVE SPROCKET FIXING ....	K1	K2	-----	-----	1	23802-040-000	0168054
10	COLLAR, GEAR .....	K1	K2	-----	-----	1	23911-041-010	0174896
	COLLAR, GEAR .....	K1	K2	-----	-----	1	23911-041-020	1092576
11	WASHER, THRUST, 14MM .....	K1	K2	-----	-----	1	90451-001-000	0004671
12	WASHER, 13.5MM .....	K1	K2	-----	-----	1	90451-035-000	0070904
13	WASHER, SPLINE, 17MM .....	K1	K2	-----	-----	3	90461-035-000	0185611
14	CIRCLIP, EXTERNAL, 17MM .....	K1	K2	-----	-----	4	90601-001-000	0003707
15	OIL SEAL, 17X29X5 .....	K1	K2	-----	-----	1	91203-035-000	0071343
	OIL SEAL, 17X29X5 (NOK) .....	K1	K2	-----	-----	1	91203-035-005	0722439
16	BOLT, HEX., 6X8 .....	K1	K2	-----	-----	2	92000-06008	0054155
	BOLT, HEX., 6X8 .....	K1	K2	-----	-----	2	92000-06008-0A	0724377
	BOLT, HEX., 6X8 .....	K1	K2	-----	-----	2	92101-06008-0A	2504868
17	BEARING, RADIAL BALL, 6203 .....	K1	K2	-----	-----	2	96100-62030	0053256
	BEARING, RADIAL BALL, 6203 .....	K1	K2	-----	-----	2	96100-62030-00	0722199

# CONTENTS

TITLE	PAGE	GRID
AIR CLEANER .....	60	D11
ALTERNATOR .....	10	B5
BATTERY .....	88	F1
BRAKE PEDAL .....	80	E9
CAM CHAIN TENSIONER .....	14	B7
CAMSHAFT .....	8	B4
CARBURETOR .....	38	C7
CHAIN CASE .....	78	E8
CHANGE PEDAL .....	98	F6
CLUTCH .....	18	B9
CRANKCASE .....	34	C5
CRANKCASE COVER, L .....	10	B5
CRANKCASE COVER, R .....	16	B8
CRANKCASE PROTECTOR .....	92	F3
CRANKSHAFT .....	22	B11
CYLINDER .....	6	B3
CYLINDER HEAD .....	6	B3
CYLINDER HEAD COVER .....	2	B1
FENDER, FR .....	46	D4
FENDER, RR .....	84	E11
FORK, FR .....	50	D6
FRAME .....	92	F3
FUEL TANK .....	64	E1
GEARSHIFT .....	26	C1
HANDLEBAR .....	40	D1
HEADLIGHT .....	44	D3
HORN .....	46	D4
INLET PIPE .....	2	B1
KICK ARM .....	98	F6
KICK STARTER .....	32	C4
MUFFLER .....	66	E2
OIL PUMP .....	34	C5
PISTON .....	22	B11
SEAT .....	60	D11
SHOCK ABSORBER, RR .....	76	E7
SIDE STAND .....	80	E9
SPARK PLUG .....	2	B1
SPEEDOMETER .....	44	D3
STEERING STEM .....	46	D4
STEP .....	80	E9
SWINGARM .....	78	E8
TAILLIGHT .....	84	E11
TOOL SET .....	96	F5
TRANSMISSION .....	30	C3
VALVE .....	8	B4
WHEEL, FR .....	54	D8
WHEEL, RR .....	70	E4
WIRE HARNESS .....	88	F1

GRID

**C3**