

HEADLIGHT • SPEEDOMETER

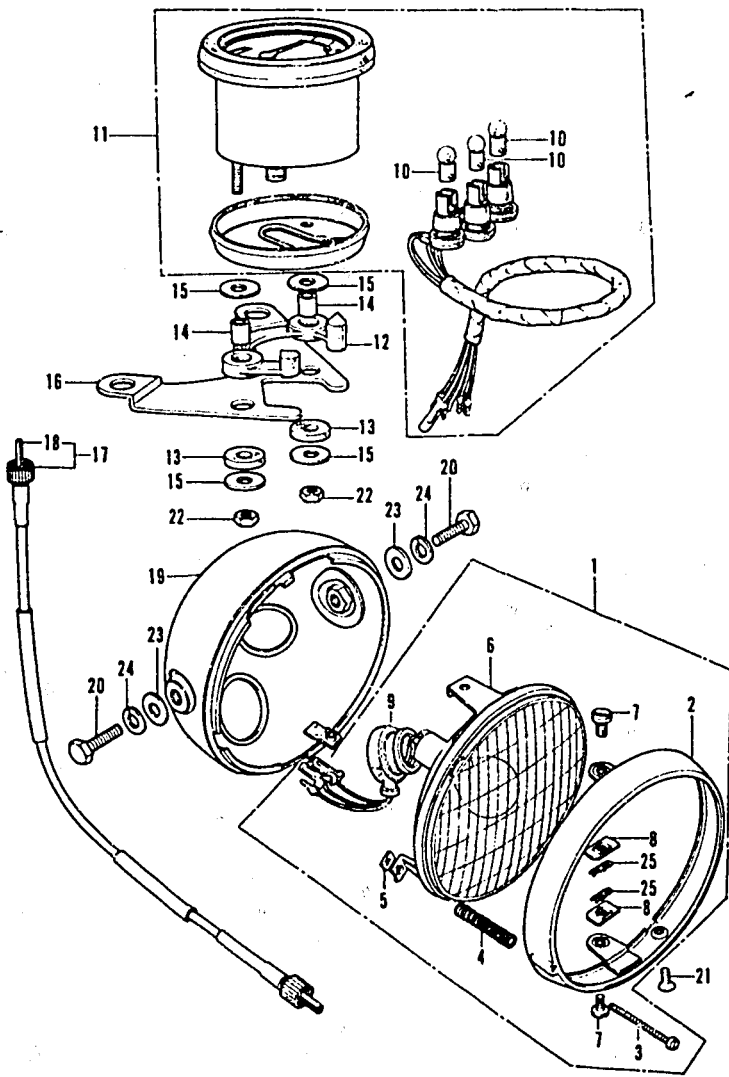

F23098002

K1 = CT70K1
K2 = CT70K2

| Ref. No. | BLOCK NO. DESCRIPTION | CT70 | | FRAME SERIAL NUMBER | QTY REQ | PART NUMBER | HONDA CODE |
|----------|-----------------------------------|------|----|---------------------|---------|----------------|------------|
| | | K1 | K2 | | | | |
| | | FROM | TO | | | | |
| 1 | HEADLIGHT ASSY. (6V15/15W) | K1 | K2 | ----- | 1 | 33100-111-671 | 0206268 |
| 2 | RIM, HEADLIGHT | K1 | K2 | ----- | 1 | 33101-111-671 | 0206276 |
| 3 | SCREW, HEADLIGHT ADJUSTING | K1 | K2 | ----- | 1 | 33102-041-670 | 0201517 |
| 4 | SPRING, HEADLIGHT SETTING | K1 | K2 | ----- | 1 | 33107-030-003 | 0019679 |
| 5 | NUT, BEAM ADJUSTING | K1 | K2 | ----- | 1 | 33117-041-003 | 0309146 |
| 6 | HEADLIGHT UNIT | K1 | K2 | ----- | 1 | 33120-111-671 | 0206284 |
| 7 | SCREW, UNIT HOLDER | K1 | K2 | ----- | 2 | 33125-292-670 | 0146423 |
| 8 | NUT, UNIT HOLDER | K1 | K2 | ----- | 2 | 33128-292-670 | 0162261 |
| 9 | COVER, RUBBER | K1 | K2 | ----- | 1 | 33130-111-671 | 0206300 |
| 10 | BULB, SPEEDOMETER (6V1.7W) | K1 | K2 | ----- | 3 | 34908-230-000 | 0148924 |
| 11 | SPEEDOMETER ASSY. (MPH) | K1 | K2 | ----- | 1 | 37200-098-950 | 0302737 |
| 12 | RUBBER, METER CUSHION | K1 | K2 | ----- | 1 | 37310-098-970 | 0267757 |
| 13 | RUBBER B, SPEEDOMETER CUSHION ... | K1 | K2 | ----- | 2 | 37311-061-810 | 0206367 |
| 14 | COLLAR, SPEEDOMETER CUSHION | K1 | K2 | ----- | 2 | 37312-061-810 | 0269472 |
| 15 | WASHER, PLAIN, 5.5MM | K1 | K2 | ----- | 4 | 37314-061-810 | 0206557 |
| 16 | STAY, SPEEDOMETER | K1 | K2 | ----- | 1 | 37315-098-972B | 0267765 |
| 17 | CABLE ASSY., SPEEDOMETER | K1 | K2 | ----- | 1 | 44830-098-970 | 0267682 |
| | CABLE ASSY., SPEEDOMETER | K1 | K2 | ----- | 1 | 44830-126-920 | 0424739 |
| | CABLE ASSY., SPEEDOMETER | K1 | K2 | ----- | 1 | 44830-126-930 | 0466151 |
| 18 | CABLE ASSY., SPEEDOMETER | K1 | K2 | ----- | 1 | 44830-098-970 | 0267682 |
| | CABLE ASSY., SPEEDOMETER | K1 | K2 | ----- | 1 | 44830-126-920 | 0424739 |
| | CABLE ASSY., SPEEDOMETER | K1 | K2 | ----- | 1 | 44830-126-930 | 0466151 |
| | CABLE, SPEEDOMETER INNER | K1 | K2 | ----- | 1 | 44831-098-970 | 0313429 |
| 19 | CASE, HEADLIGHT | K1 | K2 | ----- | 1 | 61301-111-670B | 0306514 |
| 20 | BOLT, HEX., 8X20MM | K1 | K2 | ----- | 2 | 92000-08020-0B | 0206334 |
| 21 | SCREW, OVAL, 5X8 | K1 | K2 | ----- | 1 | 93700-05008-0A | 0197434 |
| 22 | NUT, HEX., 5MM | K1 | K2 | ----- | 2 | 94001-05000-0S | 0156885 |
| 23 | WASHER, PLAIN, 8MM | K1 | K2 | ----- | 2 | 94101-08000 | 0059097 |
| 24 | WASHER, SPRING, 8MM | K1 | K2 | ----- | 2 | 94111-08000 | 0058982 |
| 25 | PIN, LOCK, 5MM | K1 | K2 | ----- | 2 | 94251-05000 | 0119305 |

CONTENTS

| TITLE | PAGE | GRID |
|---------------------------|------|------|
| AIR CLEANER | 60 | D11 |
| ALTERNATOR | 10 | B5 |
| BATTERY | 88 | F1 |
| BRAKE PEDAL | 80 | E9 |
| CAM CHAIN TENSIONER | 14 | B7 |
| CAMSHAFT | 8 | B4 |
| CARBURETOR | 38 | C7 |
| CHAIN CASE | 78 | E8 |
| CHANGE PEDAL | 98 | F6 |
| CLUTCH | 18 | B9 |
| CRANKCASE | 34 | C5 |
| CRANKCASE COVER, L | 10 | B5 |
| CRANKCASE COVER, R | 16 | B8 |
| CRANKCASE PROTECTOR | 92 | F3 |
| CRANKSHAFT | 22 | B11 |
| CYLINDER | 6 | B3 |
| CYLINDER HEAD | 6 | B3 |
| CYLINDER HEAD COVER | 2 | B1 |
| FENDER, FR | 46 | D4 |
| FENDER, RR | 84 | E11 |
| FORK, FR | 50 | D6 |
| FRAME | 92 | F3 |
| FUEL TANK | 64 | E1 |
| GEARSHIFT | 26 | C1 |
| HANDLEBAR | 40 | D1 |
| HEADLIGHT | 44 | D3 |
| HORN | 46 | D4 |
| INLET PIPE | 2 | B1 |
| KICK ARM | 98 | F6 |
| KICK STARTER | 32 | C4 |
| MUFFLER | 66 | F2 |
| OIL PUMP | 34 | C5 |
| PISTON | 22 | B11 |
| SEAT | 60 | D11 |
| SHOCK ABSORBER, RR | 76 | E7 |
| SIDE STAND | 80 | E9 |
| SPARK PLUG | 2 | B1 |
| SPEEDOMETER | 44 | D3 |
| STEERING STEM | 46 | D4 |
| STEP | 80 | E9 |
| SWINGARM | 78 | E8 |
| TAILLIGHT | 84 | E11 |
| TOOL SET | 96 | F5 |
| TRANSMISSION | 30 | C3 |
| VALVE | 8 | B4 |
| WHEEL, FR | 54 | D8 |
| WHEEL, RR | 70 | E4 |
| WIRE HARNESS | 88 | F1 |

44 AMERICAN HONDA MOTOR CO., LTD. 1993
 CT70K1 ENGINE NO.; CT70E-2000001 TO SUBSEQUENT
 CT70K1 FRAME NO.; CT70-2000001 TO SUBSEQUENT
 CT70K2 ENGINE NO.; CT70E-2100001 TO SUBSEQUENT
 CT70K2 FRAME NO.; CT70-2100001 TO SUBSEQUENT