

SEAT • AIR CLEANER

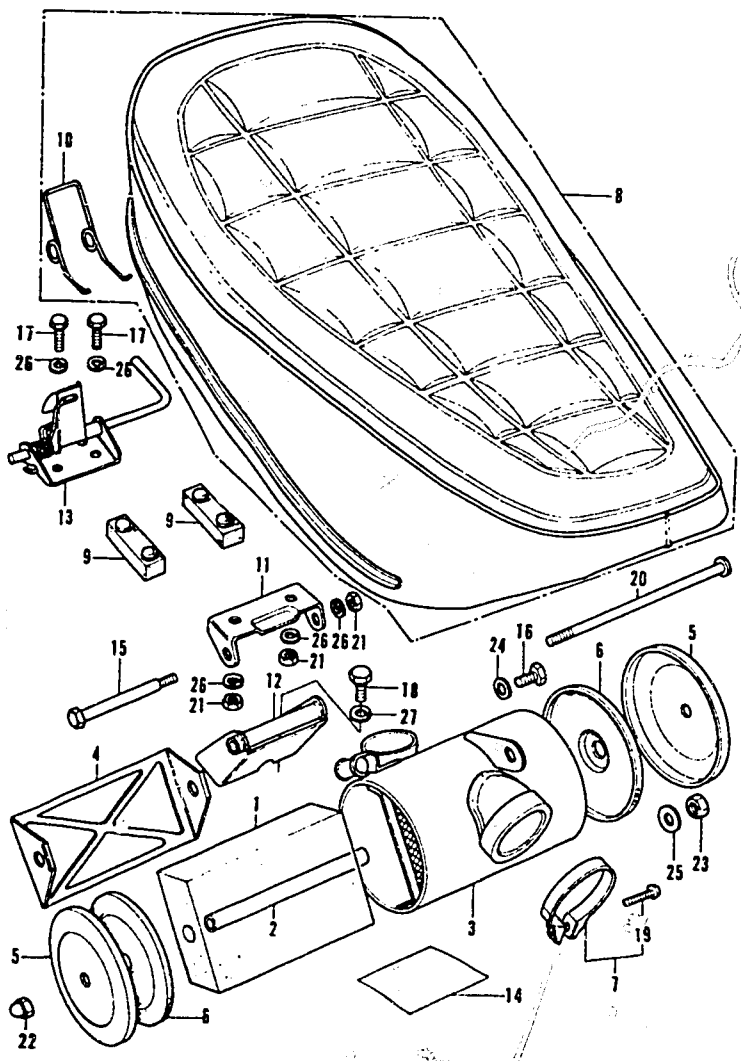

"CAUTION OR WARNING LABELS MUST BE ORDERED SEPARATELY WHEN APPLICABLE"

F23098006

K1 = CT70K1
K2 = CT70K2

| Ref. No. | BLOCK NO. DESCRIPTION | CT70 | | FRAME SERIAL NUMBER | QTY REQ | PART NUMBER | HONDA CODE |
|----------|--|------|-----|---------------------|---------|----------------|------------|
| | | K 1 | K 2 | | | | |
| | | FROM | TO | | | | |
| 1 | ELEMENT, AIR CLEANER | K1 | K2 | ----- | 1 | 17211-098-771 | 0233577 |
| 2 | PIPE, AIR CLEANER INNER | K1 | K2 | ----- | 1 | 17212-098-000 | 0356733 |
| 3 | CASE, AIR CLEANER | K1 | K2 | ----- | 1 | 17221-126-000B | 0302661 |
| 4 | PLATE, AIR CLEANER ELEMENT MOUNT | K1 | K2 | ----- | 1 | 17222-098-771 | 0233593 |
| 5 | COVER, AIR CLEANER CASE | K1 | K2 | ----- | 2 | 17231-045-030 | 0201467 |
| 6 | GASKET, AIR CLEANER CASE | K1 | K2 | ----- | 2 | 17252-098-771 | 0233601 |
| 7 | BAND B, AIR CLEANER CONNECTING ... | K1 | K2 | ----- | 1 | 17255-098-000 | 0114769 |
| 8 | SEAT ASSY. | K1 | K2 | ----- | 1 | 77200-098-950A | 0302869 |
| 9 | RUBBER B, SEAT SETTING | K1 | K2 | ----- | 2 | 77205-286-000 | J154807 |
| 10 | SPRING, TOOL MOUNT | K1 | K2 | ----- | 1 | 77207-098-310 | 0270256 |
| 11 | BRACKET A, SEAT | K1 | K2 | ----- | 1 | 77210-098-000B | 0200303 |
| 12 | BRACKET B, SEAT | K1 | K2 | ----- | 1 | 77210-126-000B | 0314161 |
| 13 | CATCH ASSY., SEAT | K1 | K2 | ----- | 1 | 77211-098-000B | 0200311 |
| 14 | LABEL, AIR CLEANER CAUTION | K1 | K2 | ----- | 1 | 87508-120-000 | 0288126 |
| 15 | PIN, SEAT HINGE | K1 | K2 | ----- | 1 | 90101-001-010 | 0011916 |
| 16 | BOLT, HEX., 6X10 | K1 | K2 | ----- | 1 | 92000-06010 | 0054171 |
| 17 | BOLT, HEX., 6X16 | K1 | K2 | ----- | 1 | 92101-06010-0A | 3307048 |
| 18 | BOLT, HEX., 6X16 | K1 | K2 | ----- | 2 | 92000-06016 | 0054239 |
| 19 | BOLT, HEX., 6X16 | K1 | K2 | ----- | 2 | 92000-06016-0A | 0313197 |
| 20 | BOLT, HEX., 6X16 | K1 | K2 | ----- | 2 | 92000-06016-1A | 0915124 |
| 21 | BOLT, HEX., 6X16 | K1 | K2 | ----- | 2 | 92100-06016-0A | 1685726 |
| 22 | BOLT, HEX., 6X16 | K1 | K2 | ----- | 2 | 92101-06016-0A | 2479590 |
| 23 | BOLT, HEX., 6X16 | K1 | K2 | ----- | 2 | 92200-06016-0A | 1842400 |
| 24 | BOLT, HEX., 8X16 | K1 | K2 | ----- | 2 | 92000-08016-0A | 0145433 |
| 25 | BOLT, HEX., 8X16 | K1 | K2 | ----- | 2 | 92101-08016-0A | 3391489 |
| 26 | SCREW, PAN, 4X25 | K1 | K2 | ----- | 1 | 93500-04025-0A | 0188367 |
| 27 | SCREW, PAN, 6X135 | K1 | K2 | ----- | 1 | 93500-06135-02 | 0250613 |
| 28 | NUT, HEX., 6MM | K1 | K2 | ----- | 3 | 90310-KA3-711 | 1553916 |
| 29 | NUT, HEX., 6MM | K1 | K2 | ----- | 3 | 94000-06000-0S | 1391283 |
| 30 | NUT, HEX., 6MM | K1 | K2 | ----- | 3 | 94001-06000 | 0058016 |
| 31 | NUT, HEX., 6MM | K1 | K2 | ----- | 3 | 94001-06000-0S | 0156067 |

CONTENTS

| TITLE | PAGE | GRID |
|---------------------------|------|------|
| AIR CLEANER | 60 | D11 |
| ALTERNATOR | 10 | B5 |
| BATTERY | 88 | F1 |
| BRAKE PEDAL | 80 | E9 |
| CAM CHAIN TENSIONER | 14 | B7 |
| CAMSHAFT | 8 | B4 |
| CARBURETOR | 38 | C7 |
| CHAIN CASE | 78 | E8 |
| CHANGE PEDAL | 98 | F6 |
| CLUTCH | 18 | B9 |
| CRANKCASE | 34 | C5 |
| CRANKCASE COVER L | 10 | B5 |
| CRANKCASE COVER R | 16 | B8 |
| CRANKCASE PROTECTOR | 92 | F3 |
| CRANKSHAFT | 22 | B11 |
| CYLINDER | 6 | B3 |
| CYLINDER HEAD | 6 | B3 |
| CYLINDER HEAD COVER | 2 | B1 |
| FENDER, FR | 46 | D4 |
| FENDER, RR | 84 | E11 |
| FORK, FR | 50 | D6 |
| FRAME | 92 | F3 |
| FUEL TANK | 64 | E1 |
| GEARSHIFT | 26 | C1 |
| HANDLEBAR | 40 | D1 |
| HEADLIGHT | 44 | D3 |
| HORN | 46 | D4 |
| INLET PIPE | 2 | B1 |
| KICK ARM | 98 | F6 |
| KICK STARTER | 32 | C4 |
| MUFFLER | 66 | E2 |
| OIL PUMP | 34 | C5 |
| PISTON | 22 | B11 |
| SEAT | 60 | D11 |
| SHOCK ABSORBER, RR | 76 | E7 |
| SIDE STAND | 80 | E9 |
| SPARK PLUG | 2 | B1 |
| SPEEDOMETER | 44 | D3 |
| STEERING STEM | 46 | D4 |
| STEP | 80 | E9 |
| SWINGARM | 78 | E8 |
| TAILLIGHT | 84 | E11 |
| TOOL SET | 96 | F5 |
| TRANSMISSION | 30 | C3 |
| VALVE | 8 | B4 |
| WHEEL, FR | 54 | D8 |
| WHEEL, RR | 70 | E4 |
| WIRE HARNESS | 88 | F1 |

CT70K1 ENGINE NO.; CT70E-2000001 TO SUBSEQUENT
 CT70K1 FRAME NO.; CT70-2000001 TO SUBSEQUENT
 CT70K2 ENGINE NO.; CT70E-2100001 TO SUBSEQUENT
 CT70K2 FRAME NO.; CT70-2100001 TO SUBSEQUENT