

**REAR WHEEL**

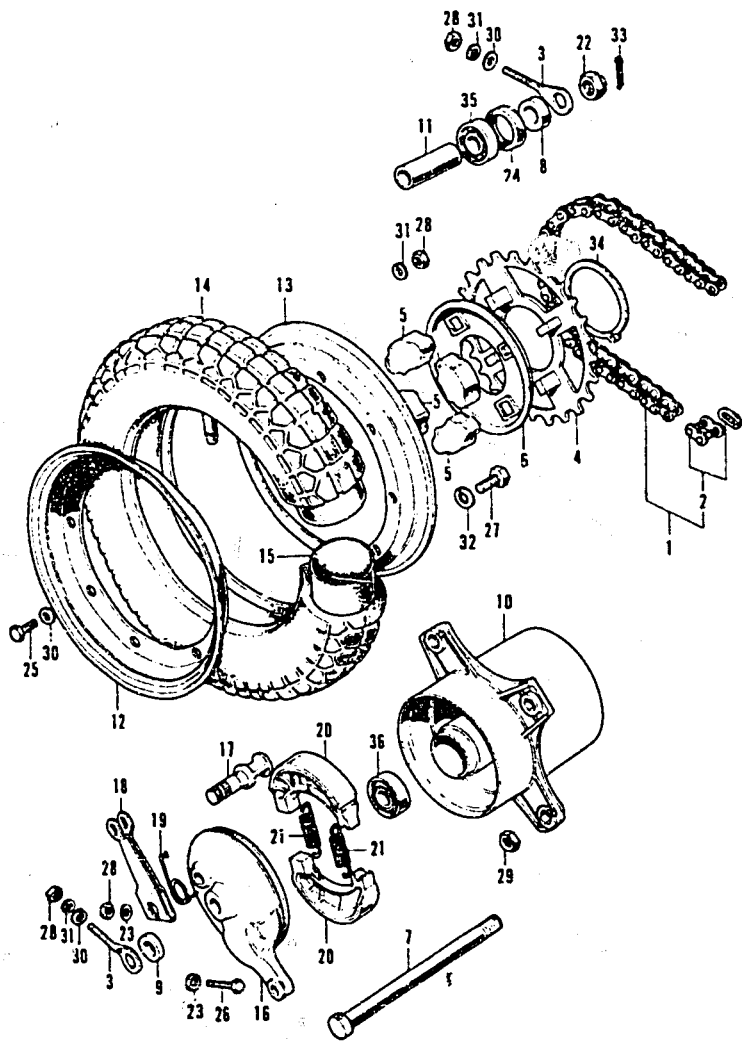

F23098000

Ref. No.	BLOCK NO. DESCRIPTION	CT70		FRAME SERIAL NUMBER	QTY REQ	PART NUMBER	HONDA CODE
		K1	K2				
		1	2				
				FROM	TO		
		K1	K2				
28	NUT, HEX., 6MM	K1	K2			94000-06000-0S	1391283
	NUT, HEX., 6MM	K1	K2			94001-06000	0058016
	NUT, HEX., 6MM	K1	K2			94001-06000-0S	0156067
	NUT, HEX., 6MM	K1	K2			94001-06008-0S	2829414
	NUT, HEX., 6MM	K1	K2			94001-06200-0S	2043255
	NUT, HEX., 6MM	K1	K2			94030-06000	1642693
29	NUT, HEX., 8MM	K1	K2			94001-08000-0S	0167338
30	WASHER, PLAIN, 6MM	K1	K2			94101-06000	0059071
	WASHER, PLAIN, 6MM	K1	K2			94101-06080	3136074
	WASHER, PLAIN, 6MM	K1	K2			94101-06800	0345900
31	WASHER, SPRING, 6MM	K1	K2			94111-06000	0058974
32	WASHER, SPRING, 8MM	K1	K2			94111-08000	0058982
33	PIN, SPLIT, 3.0X25	K1	K2			94201-30250	0058420
	PIN, COTTER, 3X30	K1	K2			94201-30300	0058438
	PIN, SPLIT, 3.0X40	K1	K2			94201-30400	0058446
	PIN, SPLIT, 3.0X45	K1	K2			94201-30450	0058453
34	CIRCLIP, EXTERNAL, 50MM	K1	K2			94510-50000	0118190
35	BEARING, RADIAL BALL, 6301U	K1	K2			96100-63010	0053314
	BEARING, RADIAL BALL, 6301U	K1	K2			96140-63010	0053322
	BEARING, RADIAL BALL, 6301U	K1	K2			96140-63010-10	0287102
36	BEARING, RADIAL BALL, 6301U	K1	K2			96140-63010	0053322
	BEARING, RADIAL BALL, 6301U	K1	K2			96140-63010-10	0287102

**CONTENTS**

TITLE	PAGE	GRID
AIR CLEANER	60	D11
ALTERNATOR	10	B5
BATTERY	88	F1
BRAKE PEDAL	80	E9
CAM CHAIN TENSIONER	14	B7
CAMSHAFT	8	B4
CARBURETOR	38	C7
CHAIN CASE	78	E8
CHANGE PEDAL	98	F6
CLUTCH	18	B9
CRANKCASE	34	C5
CRANKCASE COVER, L	10	B5
CRANKCASE COVER, R	16	B8
CRANKCASE PROTECTOR	92	F3
CRANKSHAFT	22	B11
CYLINDER	6	B3
CYLINDER HEAD	6	B3
CYLINDER HEAD COVER	2	B1
FENDER, FR.	46	D4
FENDER, RR.	84	E11
FORK, FR.	50	D6
FRAME	92	F3
FUEL TANK	64	E1
GEARSHIFT	26	C1
HANDLEBAR	40	D1
HEADLIGHT	44	D3
HORN	46	D4
INLET PIPE	2	B1
KICK ARM	98	F6
KICK STARTER	32	C4
MUFFLER	66	E2
OIL PUMP	34	C5
PISTON	22	B11
SEAT	60	D11
SHOCK ABSORBER, RR.	76	F7
SIDE STAND	80	E9
SPARK PLUG	2	B1
SPEEDOMETER	44	D3
STEERING STEM	46	D4
STEP	80	E9
SWINGARM	78	E8
TAILLIGHT	84	E11
TOOL SET	96	F5
TRANSMISSION	30	C3
VALVE	8	B4
WHEEL, FR.	54	D8
WHEEL, RR.	70	E4
WIRE HARNESS	88	F1

CT70K1 ENGINE NO.; CT70E-2000001 TO SUBSEQUENT  
 CT70K1 FRAME NO.; CT70-2000001 TO SUBSEQUENT  
 CT70K2 ENGINE NO.; CT70E-2100001 TO SUBSEQUENT  
 CT70K2 FRAME NO.; CT70-2100001 TO SUBSEQUENT