

CT90K4

COMPARISON OF CT90K4 TO CT90K3

1. CAM CHAIN TENSIONER

The cam chain tensioner was changed from the hydraulic self-adjusting type to the manually adjustable type.

Adjustment

Make tension adjustment while the engine is idling.

1. Loosen the lock nut and loosen the tensioner adjusting bolt approximately one half turn.

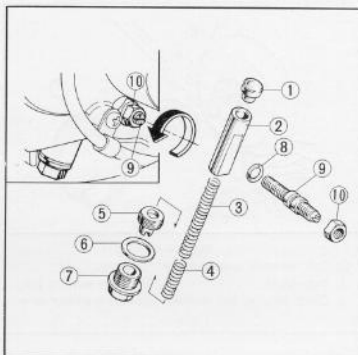

Fig. K4.1

- | | |
|---------------------------|----------------------------|
| ① Tensioner push rod head | ⑥ Sealing washer |
| ② Tensioner push rod | ⑦ 14 mm sealing bolt |
| ③ Tensioner spring A | ⑧ O-ring |
| ④ Tensioner spring B | ⑨ Tensioner adjusting bolt |
| ⑤ Tensioner bolt | ⑩ Lock nut |

2. If the chain is still noisy even after the adjustment above, loosen the 14 mm sealing bolt located at the left bottom side of the crankcase, and screw in the tensioner bolt gradually until it is no longer noisy.

After completing the adjustment, tighten the tensioner adjusting bolt lock nut and 14 mm sealing bolt securely.

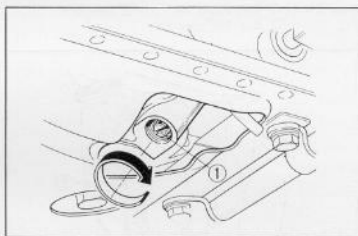

Fig. K4.2 ① Tensioner bolt