

- (1) Spark Plug (Wear, damage, coloration)
 - Fuel tank

- (2) Carburetor Choke (Operation)

- (3) Steering Head Bearing (Damage)

- (4) Clutch Master Cylinder (Level check, fluid replacement)

- (5) Clutch Lever (Free play)

- (6) Valve Clearance (Inspection/Adjustment; page 3-5)
 - Fuel tank
 - Lower fairing

- (7) Synchronization Adjusting Screw (Carburetor synchronization; page 3-8)
 - Fuel tank
 - Lower fairing

- (8) Throttle Stop Screw

- (9) Battery (Fluid level)
 - Seat

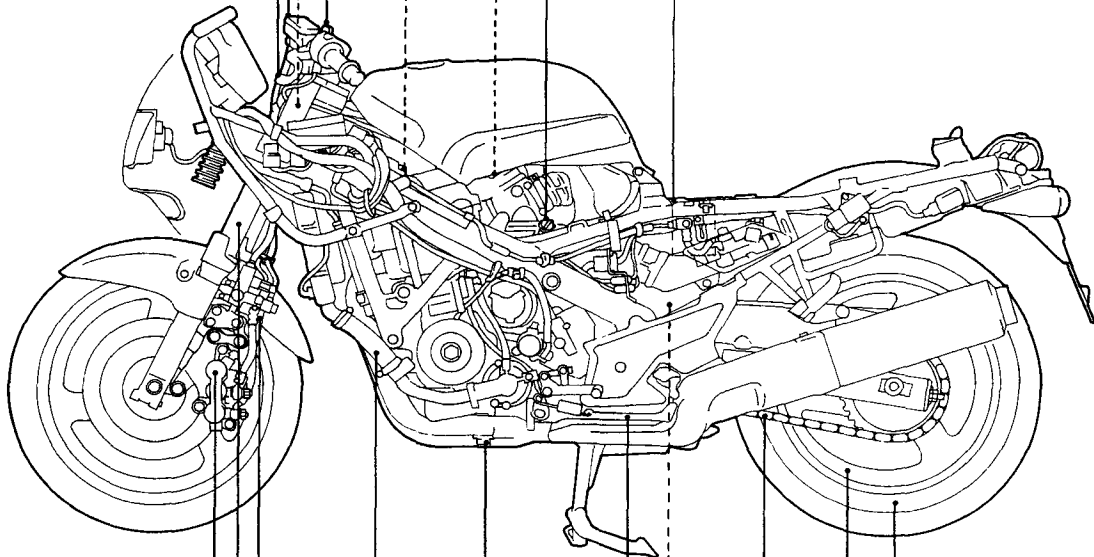

- (10) Front Brake Caliper (Pad wear)

- (11) Front Suspension (Loose, wear, damage)

- (12) Brake Hose (Leakage, deterioration, damage)

- (13) Radiator Hose (Leakage, deterioration, damage)
 - Lower fairing

- (14) Tire (Wear, damage, air pressure)

- (15) Wheel (Damage, runout, corrosion)

- (16) Drive Chain (Free play, lubrication, replacement; page 3-10)

- (17) Rear Suspension (Loose, wear, damage)

- (18) Side Stand (Operation)

- (19) Engine Oil Drain Bolt (Oil replacement)