

ASSEMBLY

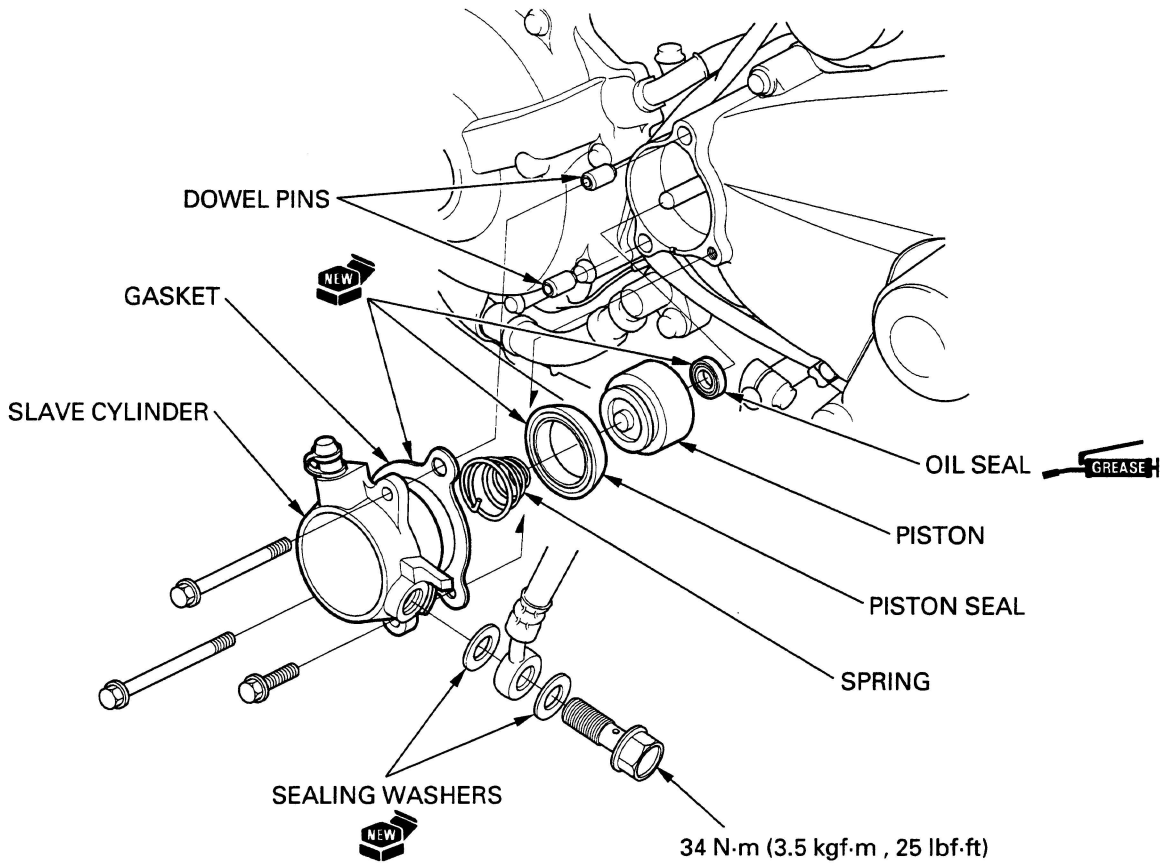

Apply small amount of silicone grease to the lifter rod contacting area of the piston.
 Apply grease to new oil seal lips and install the oil seal into the piston.
 Install a new piston seal into the piston groove.
 Install the piston spring onto the piston.

Coat the piston and piston seal with clutch fluid and install piston and spring into the slave cylinder.

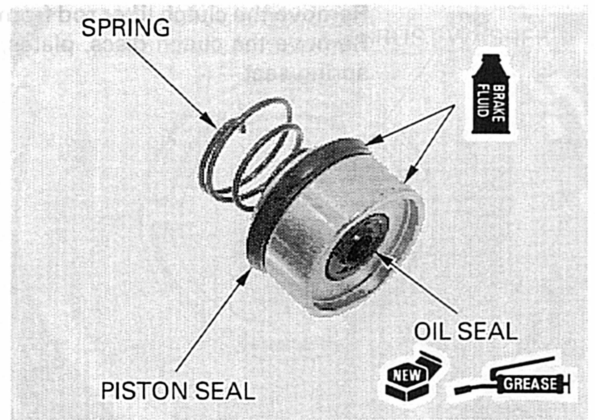

Install the dowel pins and a new gasket.

